

Product Data Sheet

GRM Thermal Break Pads

Benefits:

- Reduces heat transfer between structural members
- Limited creep under load
- Flame resistant
- Washers and bushings insulate bolts

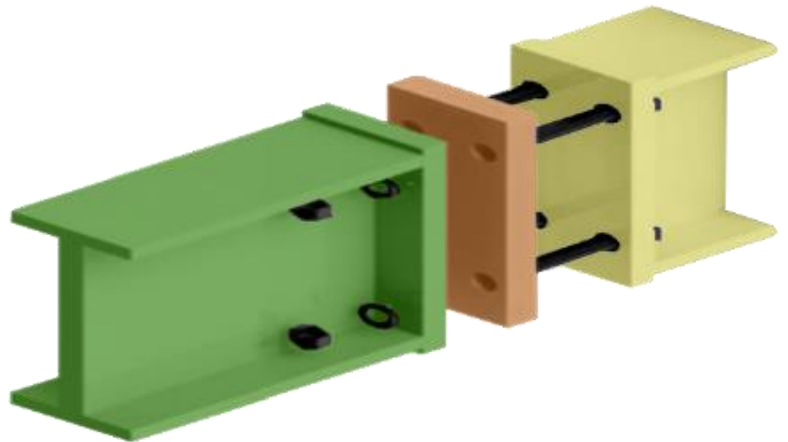

Design Data:

- Machined and fabricated to your design
- Typical thicknesses: 1/2", 3/4", 1", 2"



Typical Specifications:

Properties	Test Method	Typical Results
Compressive Strength:	ASTM D638	45,000 psi.
Compressive Modulus:	ASTM D695	1,450,000 psi.
Shear Strength:	ASTM D732	16,000 psi.
Thermal Conductivity:	ASTM C518	1.05 BTU in/ hr sf degree F.
Coefficient of Thermal Expansion:	ASTM E831	2.2 x 10e-6 in/in/degree F.
Thermal Resistance (R value):	ASTM C518	0.95 hr sf degree F/ BTU.
Surface Burning Characteristics:	ASTM E84	Flame Spread: 25 (class A)
		Smoke Developed: 50 (class A)

www.grmcp.com

(936) 441-5910

11133 I-45 S. Suite Q
Conroe, TX 77302



Request a quote:

sales@grmcp.com

Design or specification help:

eng@grmcp.com